

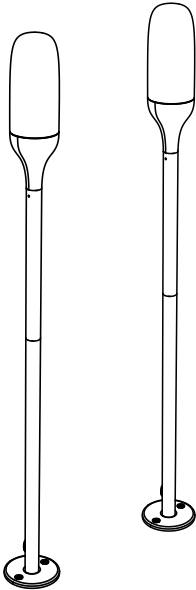

17818/**/16

Gebruiksaanwijzing
Notice d'emploi
Benutzerhandbuch
User manual
Manual de usuario



PHILIPS

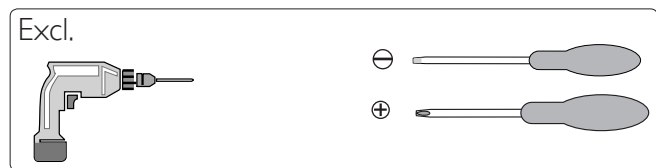
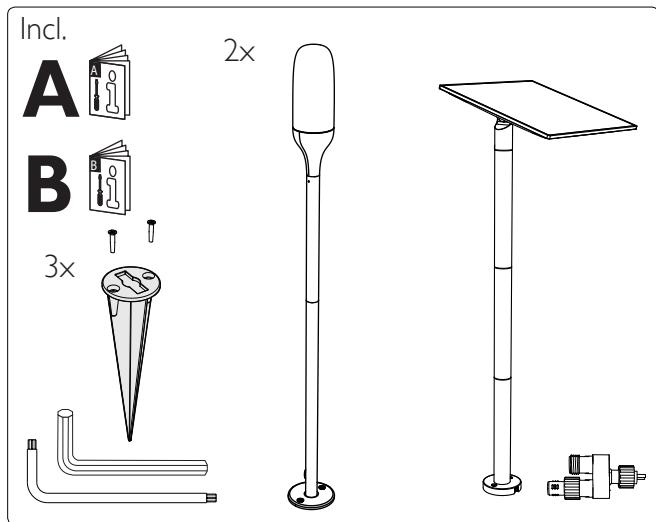

Type 1

→ p.4



Type 2

→ p.5

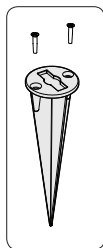
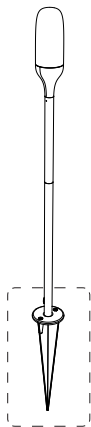

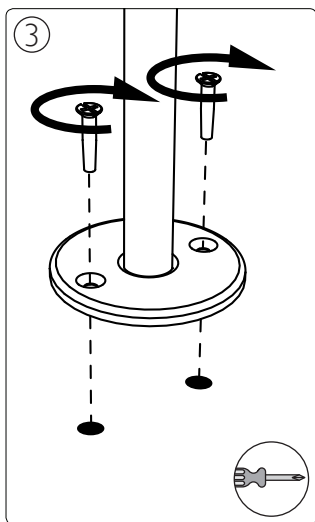
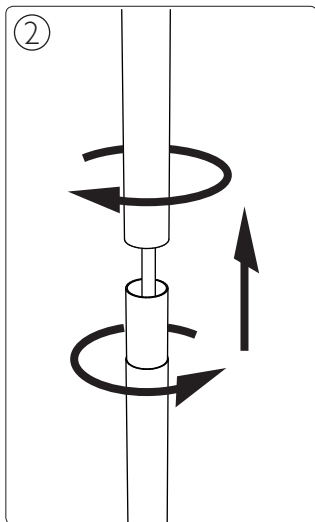
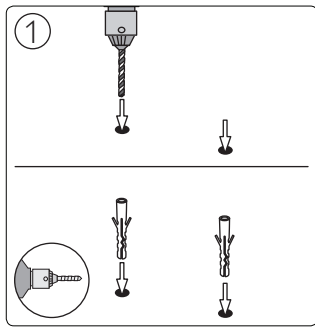
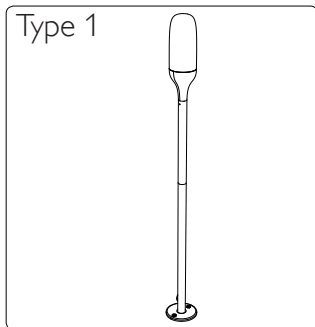

➔ p.6

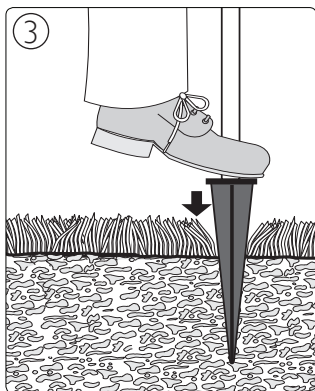
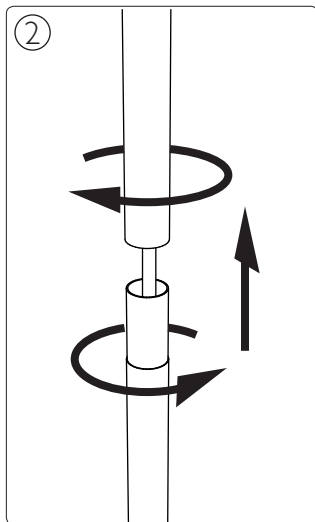
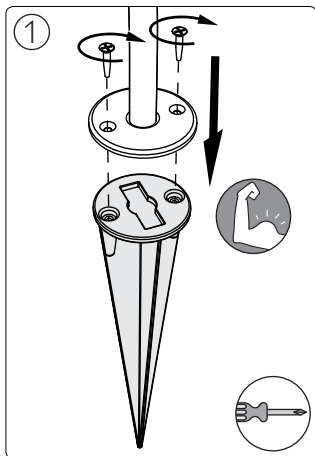
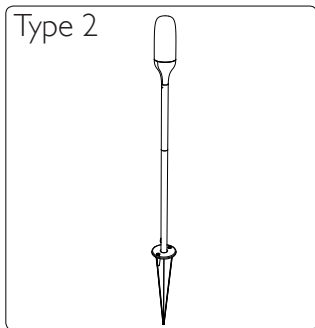

→ p.6

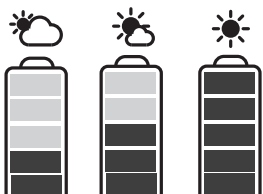
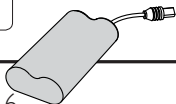
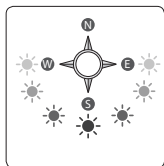
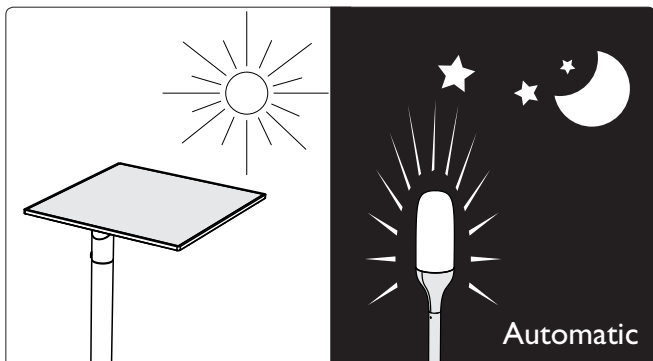

Incl.
1x 17824/30/16
= 7,4V Li-ion 2200mah

max
2h

max
4h

max
6h

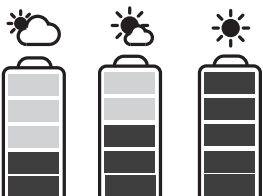
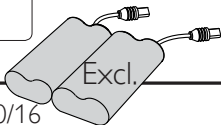
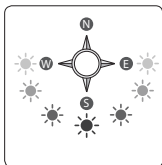

2x 17824/30/16
= 7,4V Li-ion 4400mah

max
4h

max
8h

max
12h

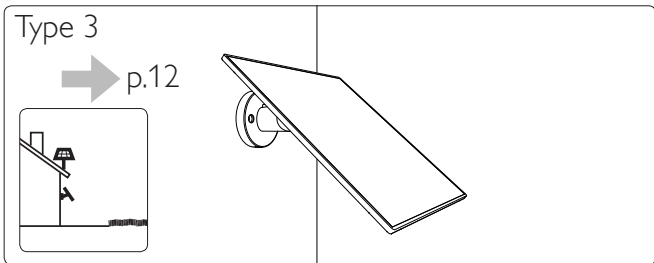
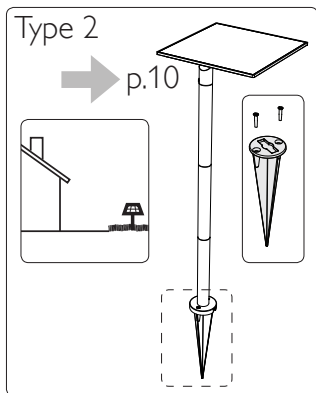
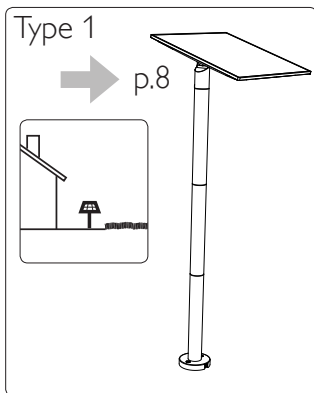
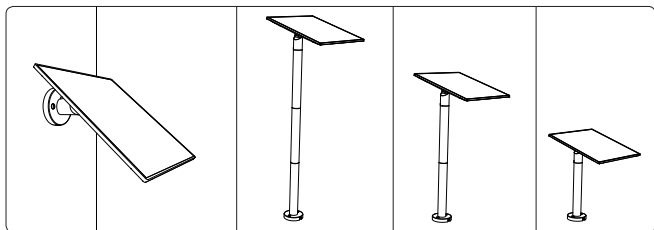

Type 1

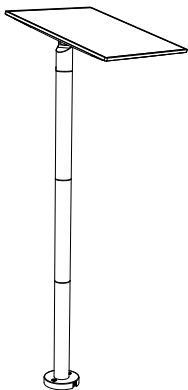

①

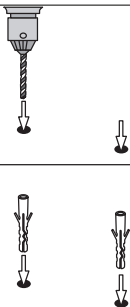

②

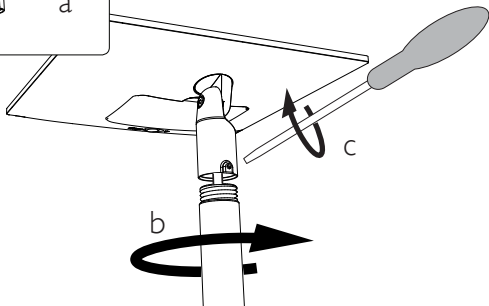
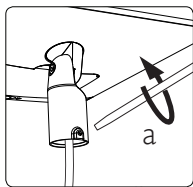

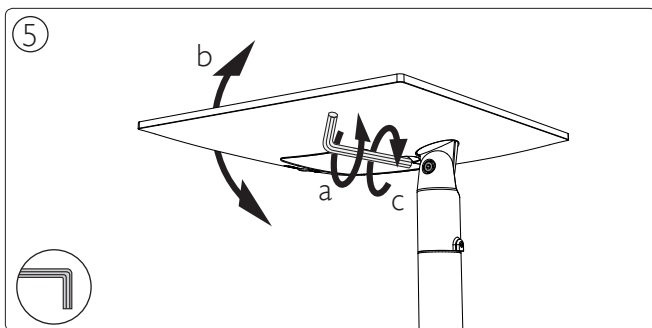
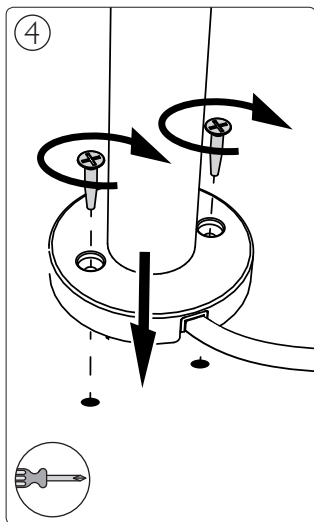
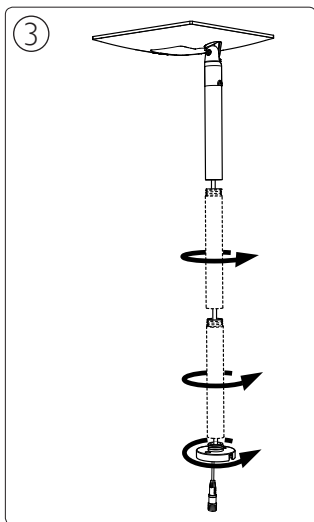

➔ p.14

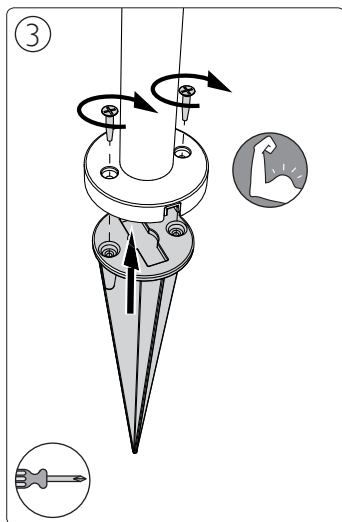
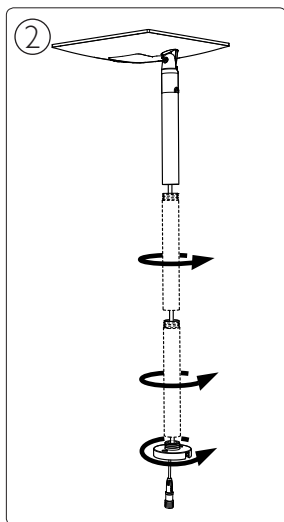
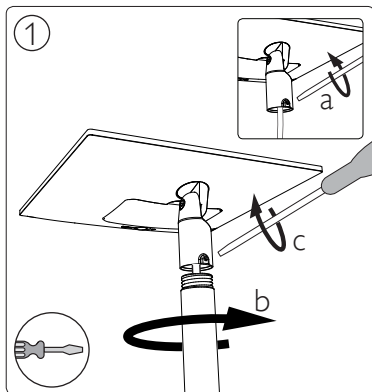
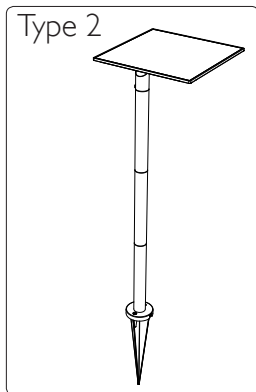

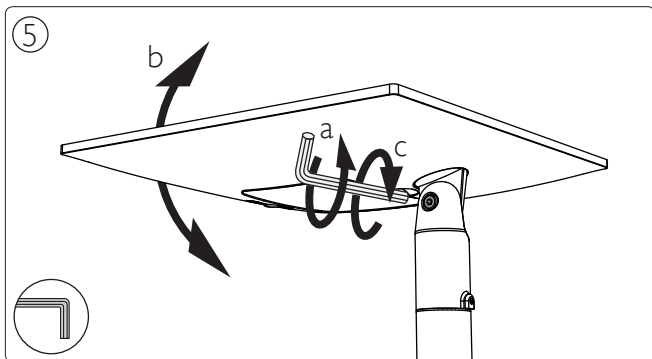
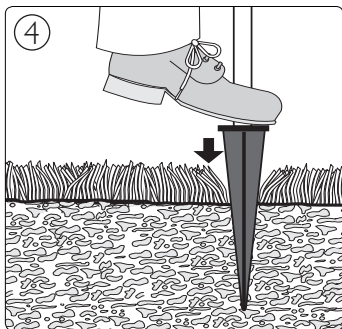

➔ p.14

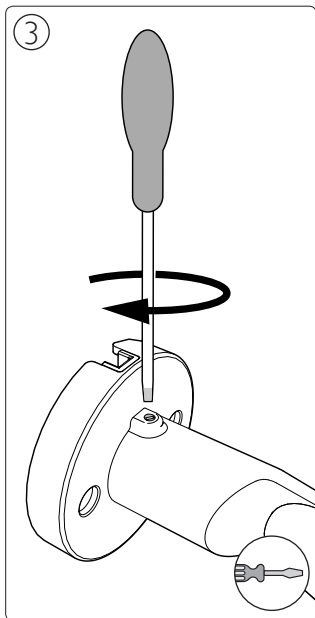
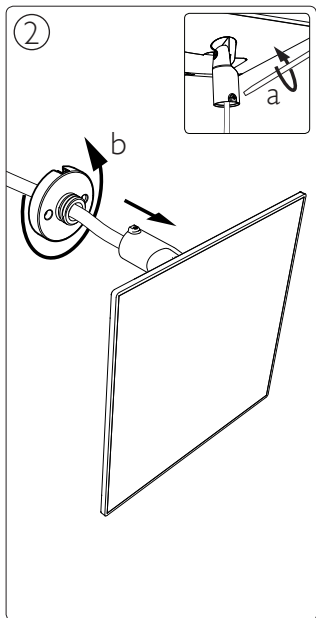
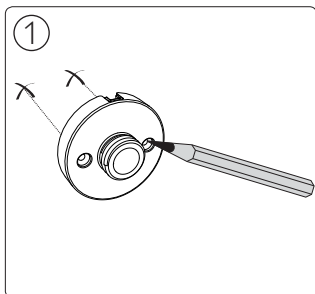
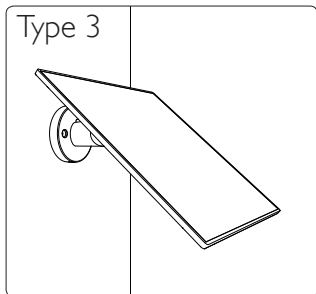

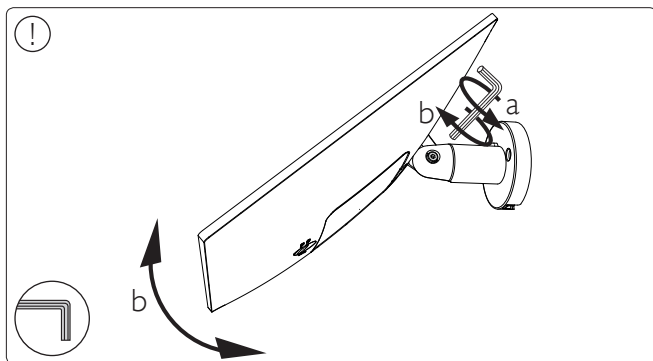
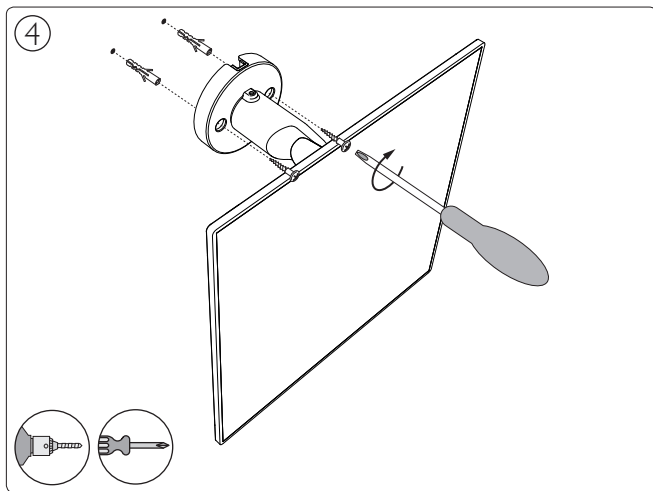

➔ p.14

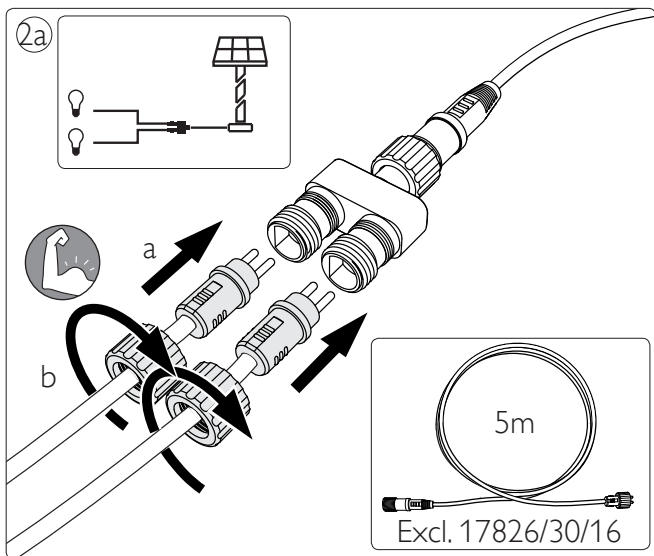
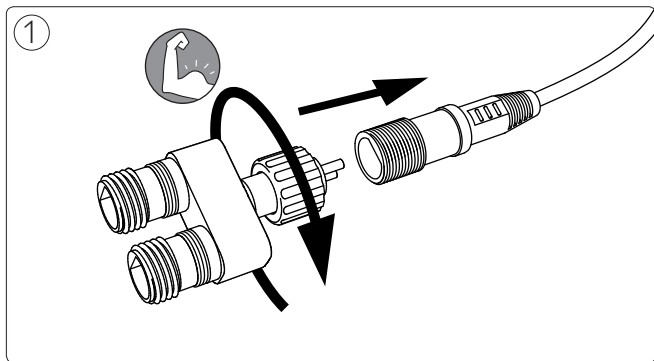

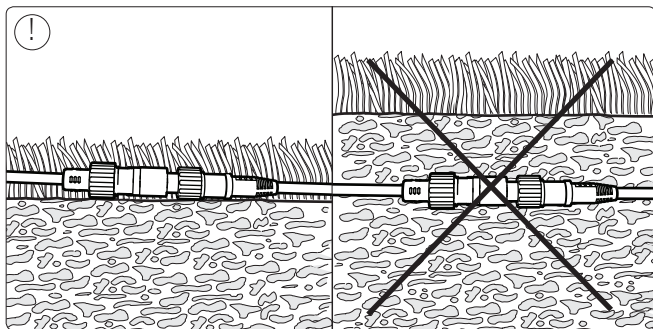
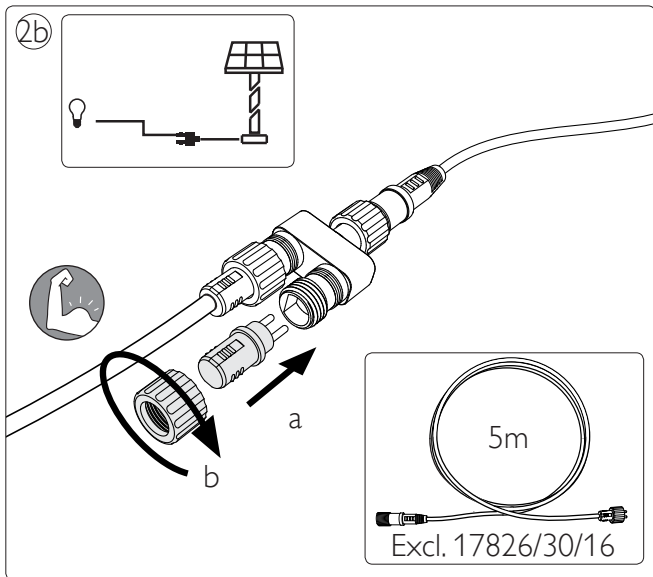

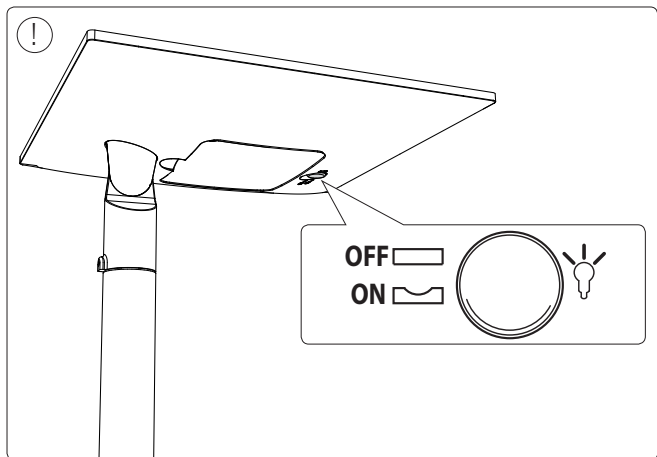

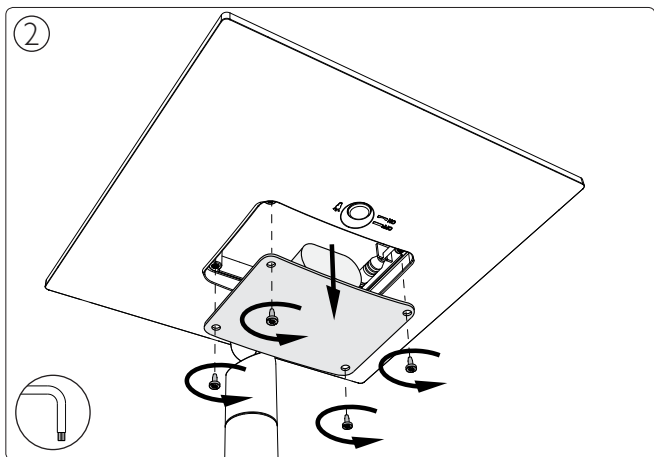
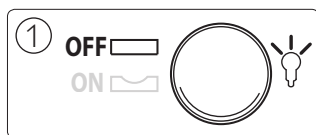
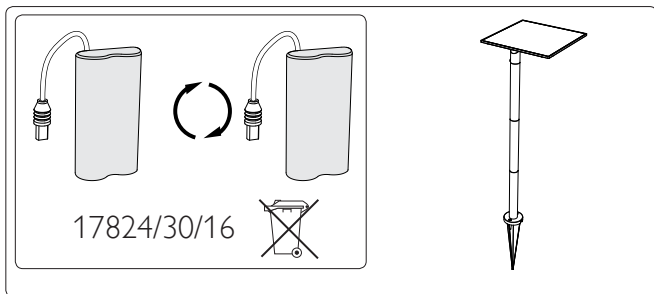

3

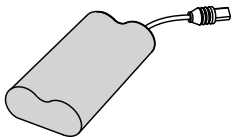
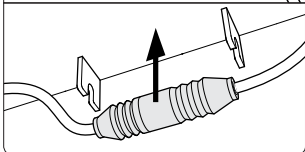
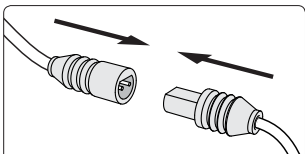
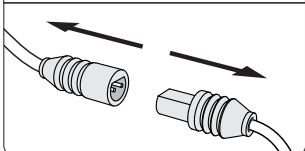
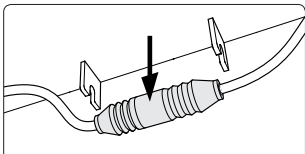
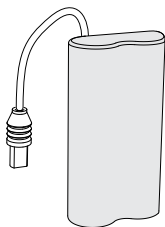
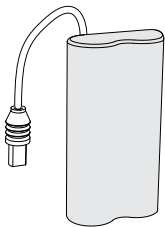

Incl.
1x 17824/30/16
= 7,4V Li-ion 2200mah

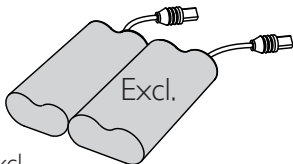

Excl.
2x 17824/30/16
= 7,4V Li-ion 4400mah

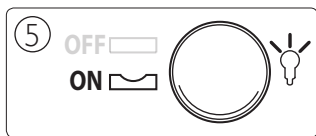
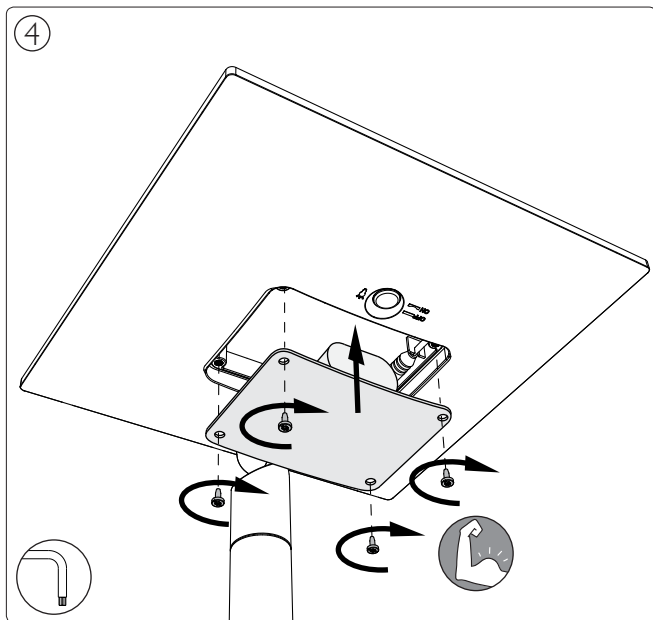



Philips Lighting Contact Centre
Int. Business Reply Service
I.B.R.S. / C.C.R.I. Numéro 10461
5600 VB Eindhoven
Pays-Bas / The Netherlands

www.philips.com/homelighting
☎ +800 7445 4775

4404.016.95791
Last update: 18/10/13